



MEDIATOR XL

Enclosed Emitter Sight User Manual

MDXLRD- Red Illumination

MDXLGN- Green Illumination



Thanks for choosing Gideon Optics. This short manual will help you understand the features of your new optic, how to mount it, how to change the battery, and how to use it.

TORQUE SPECS

Outer Shield To Optic Body:
15 Inch Pounds

Optic to 1913 MIL STD Rail:
35 Inch Pounds

WARNINGS:

1. DO NOT observe the sun directly while looking through the optic. The lens coatings are not dark enough to prevent damage to your eyes if you look directly at the sun.
2. Never put this product in a place close to a heat source or a place of high temperature for an extended period of time, like an oven. If you want to change colors, please use the air-dry variants of Duracoat / Cerakote or simple spray paint.
3. Never leave the optic, mounts, batteries or screws in reach of children or pets, to avoid the potential danger of swallowing.

Specifications

Magnification: 1x

Lens Dimensions: 28mm tall x 38mm wide

Elevation/Windage adjustment range: 45 MOA (Total 90 MOA)

Click Value: 0.5 MOA per click

Circle Dot Reticle: User Selectable 3 MOA Dot + 68 MOA Circle

Dot Colors: Red or Green Emitter

Parallax Free: At 100 yards

Dot Brightness Setting: 10 levels (8 Daytime, 2 NV Compatible)

Power Supply: 1x CR123A 3V Lithium battery

Auto Wake/Sleep: 225 Seconds after no movement

Shockproof & Waterproof

Dimensions: (LxWxH) 70mm x 56.2mm x 68.6mm

Weight (with battery installed): 13.7 oz (approx.)

How to Install/Change the CR1233A Battery

Mediator XL features a side-mounted battery compartment so the removal of the optic from its mount is not necessary when changing batteries. Using a non-marring flat blade tool, turn the battery cap counter-clockwise to access the battery compartment. Remove the old CR123A battery and replace with a new 3V CR123A. The “+” side should face to the right, towards the battery cap. Replace the cap by turning it clockwise. Be careful not to cross-thread to avoid damage to the threads. To avoid stripping out the battery compartment cap, do not over torque it. There is no torque spec on the battery cap, just stop turning when it no longer turns easily.

Power On

Press the arrow-shaped UP button (on the left side of the optic body) to turn on the sight.

Motion Activation

Mediator XL features an automatic timeout and motion sensitive “shake to awake” feature. If the optic is not bumped or moved for 225 seconds, the dot will turn off and the optic will enter a low power state, extending battery life. When the optic is bumped or moved, the dot will immediately power on and return to the previously selected brightness level. The motion sensor is very responsive—when carrying a firearm with Mediator XL mounted, or when placed in a vehicle with the engine running, the unit will remain awake continuously.

Power Off

Mediator XL can be completely powered off by holding the arrow-shaped DOWN button (on the left side of the optic body) for three seconds.

NOTE: This is a complete power off that disables the motion-sensitive “wake” function. This is recommended for long term storage, or travel when the optic will not be used. After being shut down manually, Mediator XL will return to the previously selected brightness level when powered back on with a press of the UP button.

Brightness Adjustment

Mediator XL is equipped with 10 brightness settings. Use the UP and DOWN buttons to quickly toggle through the different brightness levels. Always select the lowest brightness setting that still provides good contrast against the target. The higher brightness settings should only be used in bright daylight (otherwise, the reticle will bloom and possibly distort). The two dimmest settings are intended for use in conjunction with night vision devices and will be very difficult to see with the naked eye even in darkness.

Brightness Level Lock Out

Mediator II includes a brightness “lock-out” mode to help prevent inadvertent brightness changes or powering off during carry. To lock your brightness buttons, hold down both buttons simultaneously for three seconds until you see the reticle blink **once**. Motion Activation is still functional while brightness is locked. To deactivate the lock, hold down both buttons simultaneously again for three seconds until you see the reticle blink **twice**. Now you can cycle brightness levels up and down again.

Mounting the Sight

Mediator XL comes in two variations, a traditional mount using twin T25 bolts, and a QD lever version. The traditional mount is rated to 35 inch pounds of torque on the bolts. Blue threadlocker applied to the bolt threads can help keep the bolts from loosening up due to the vibrations of firing over time.

The Mediator XL QD variant mounts to MIL STD 1913 “Picatinny” rails via an adjustable quick detach (QD) lever mount built into the optic body. While there is a theoretical ideal specification for the 1913 rail, in practice there can be a lot of variance in rail dimensions. A T10 adjustable bolt on the left side of Mediator XL increases lateral tension on the QD lever when turned clockwise and decreases tension when turned counter-clockwise. To set a reasonable degree of tension on your rail, use the following procedure:

1. Open the QD latch on the right side of the optic by pressing the locking tab inside the lever to the rear and pulling the back of the lever away from the optic, rotating it forward toward the battery compartment. Test to see if the optic will fit easily on your rail with the lever open.
2. If Mediator XL doesn't easily fit on your rail with the QD lever all the way open, turn the T10 bolt located on the left side of the scope body counter-clockwise until the optic fits easily on your rail.
3. Close the QD lever by pulling it towards the rear of the optic. You can see the locking latch move when the lever reaches the end of its travel and hear it click into place.

If the lever will not close or requires an excessive amount of force to close, loosen the T10 bolt a few clicks at a time until you can close and lock the QD lever with just a firm press using your thumb.

If the lever closes easily and the optic is still loose, hold the optic onto the rail with the lever closed and tighten the T10 bolt by turning clockwise until the optic feels tight to the rail. Then open the QD lever, turn the bolt clockwise two or three more clicks, and close the lever again. It should take a firm press with your thumb, but not an extreme amount of pressure to close and lock the QD lever.

Reticle Selection

Mediator XL features a 3 MOA dot reticle optionally surrounded by a circle measuring 68 MOA. To change between dot, circle-dot, and circle-only reticles, press the UP button and hold it for approximately three seconds. This will cycle between the three available reticles- dot, circle dot, and circle without dot. If the optic is manually powered off, the optic will return to the previously selected reticle type automatically when powered back on.

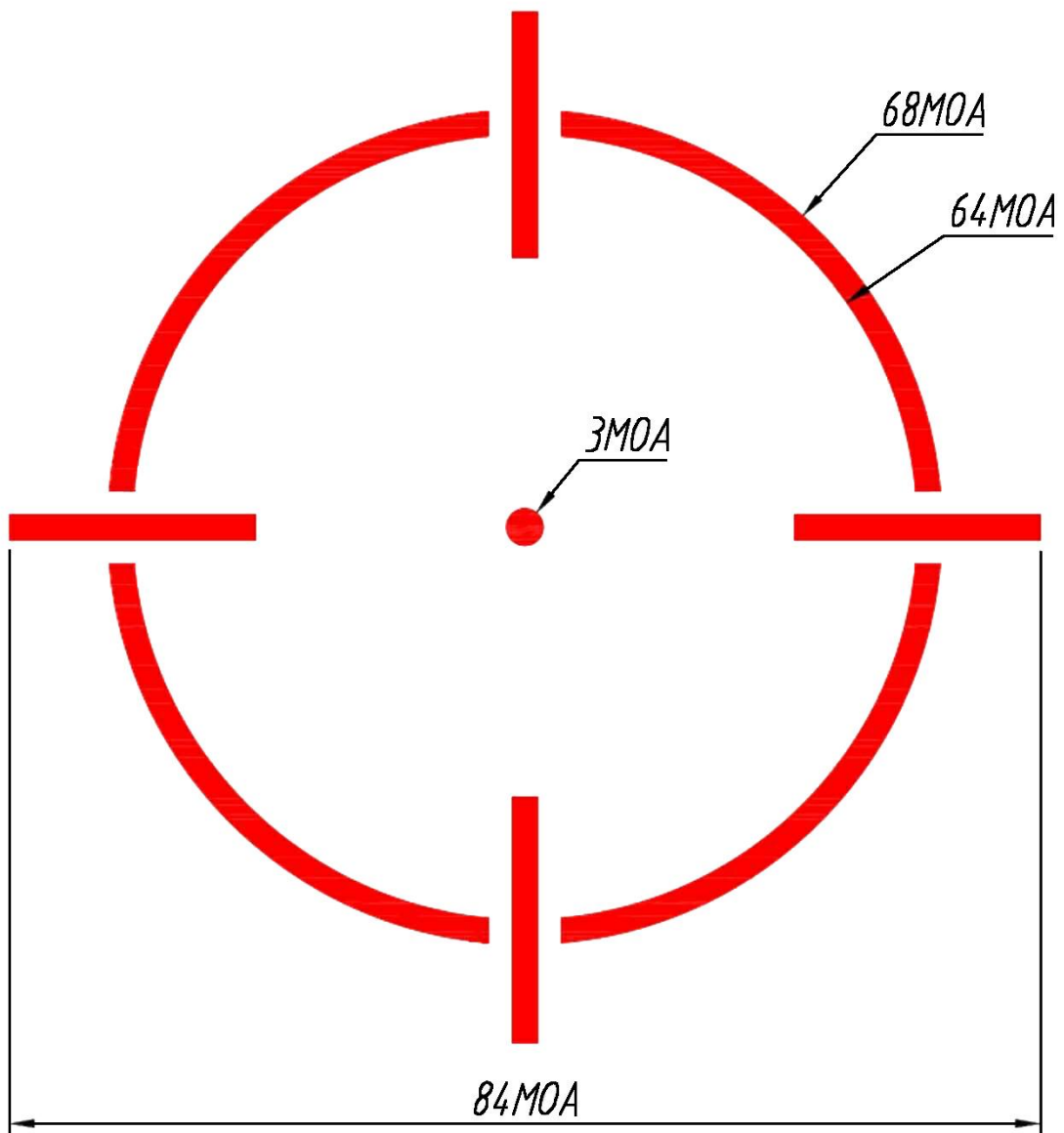

Reticle, Elevation/Windage Adjustment

The elevation and windage dials of this sight feature audible and tactile clicks. Each click will move the point of impact about 0.5 Minute of Angle (MOA), approximately 1/2 inch at 100 yards, or 1/4 inch at 50 yards. For zeroing and precision shooting, always select the lowest brightness setting that still provides good contrast against the target to help the reticle be as crisp and sharp as possible.

Parallax

This sight has been carefully designed to be parallax free at 100 yards. At distances closer than 100 yards, parallax shift should be so minor that it is irrelevant. At distances significantly greater than 100 yards, some parallax may be observed. To reduce the possibility of a point of impact (POI) shift caused by parallax for precision shooting at longer distances, the reticle should be kept in the middle 2/3 of the field of view when aiming.

Zeroing

Please note that the reticle comes from the factory “centered” in the middle of its adjustment range. Only minor windage and elevation adjustments should be required to zero. If significant adjustments appear necessary, please make sure the sight is properly mounted. This is not a defect of the optic.

After properly mounting the optic to the firearm, fire a 3-shot group and observe the point of impact using an average of the group. Initial zeroing at shorter ranges is recommended before fine-tuning the optic for longer ranges. Zeroing at extremely short distances (10 yards or closer) will likely not provide a true zero at longer ranges due to the angle created by the optic’s centerline height over bore.

Using a small flathead screwdriver, set the elevation dial (top of optic) and the windage dial (side of optic) to adjust the alignment of the reticle. The rotation directions engraved on the optic refer to point of impact shift, not the position of the dot inside the window. After making your adjustments, fire another 3-shot group to confirm the change in point of impact. Repeat as necessary.

Maintenance:

REMOVING THE ANTI-REFLECTIVE DEVICE (ARD)

Mediator XL comes with an aluminum honeycomb ARD installed in the box. To remove the ARD and clean the front lens, first use a T10 wrench to remove the four screws holding the stainless-steel protective cage onto the optic body by turning them counter-clockwise. Pull the cage straight up to remove it, as shown in Figure 1. The screws are highlighted in red.

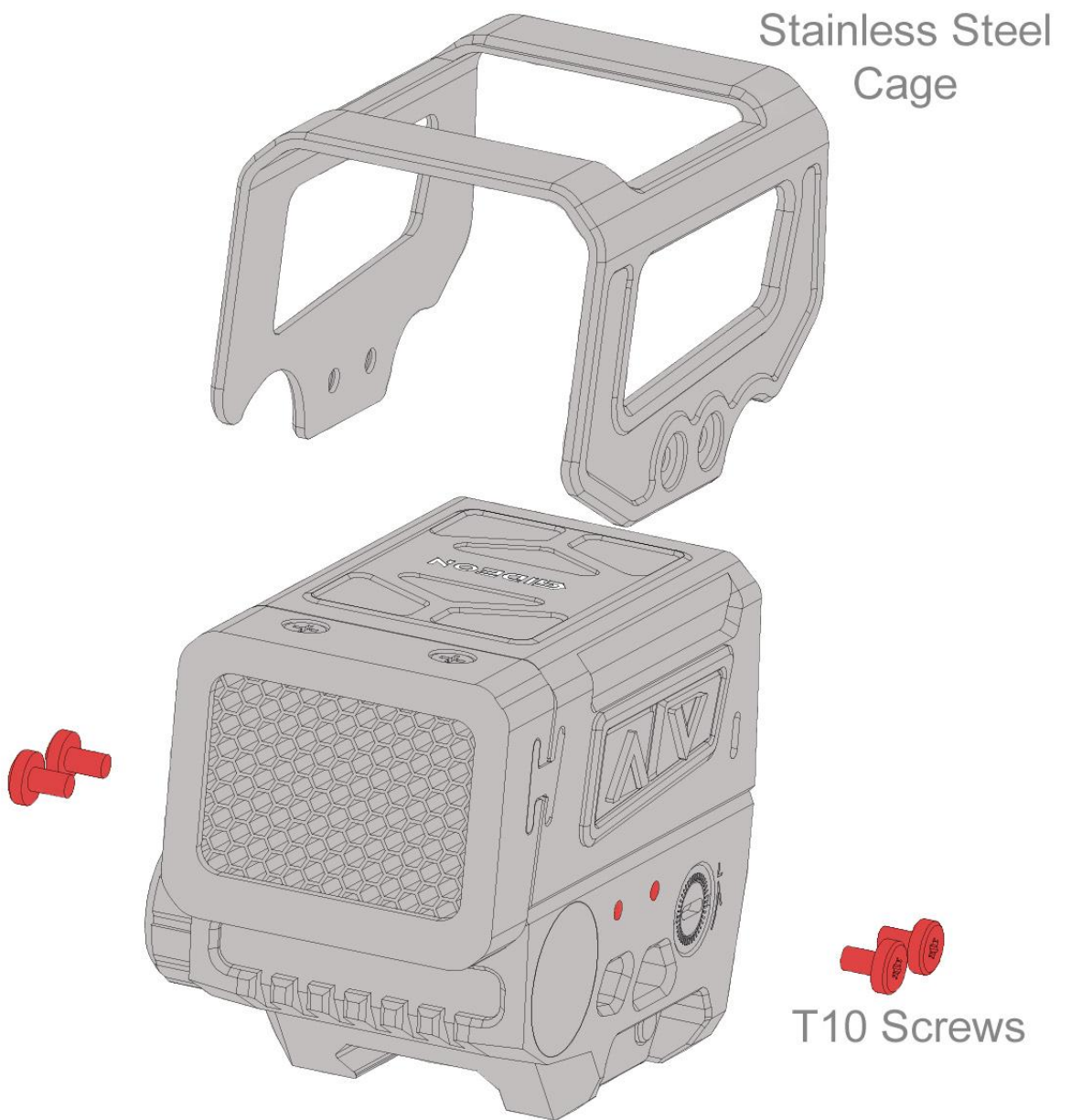

Figure 1

Next, locate two H-shaped retainers on each side of the ARD and press them firmly inwards, towards the center of the optic. You can then wiggle the ARD off of the front lens of Mediator XL. The retainers are highlighted in red in Figure 2. There are also two Philips head screws in the top of the ARD itself. You can ignore those, they hold the ARD assembly together.

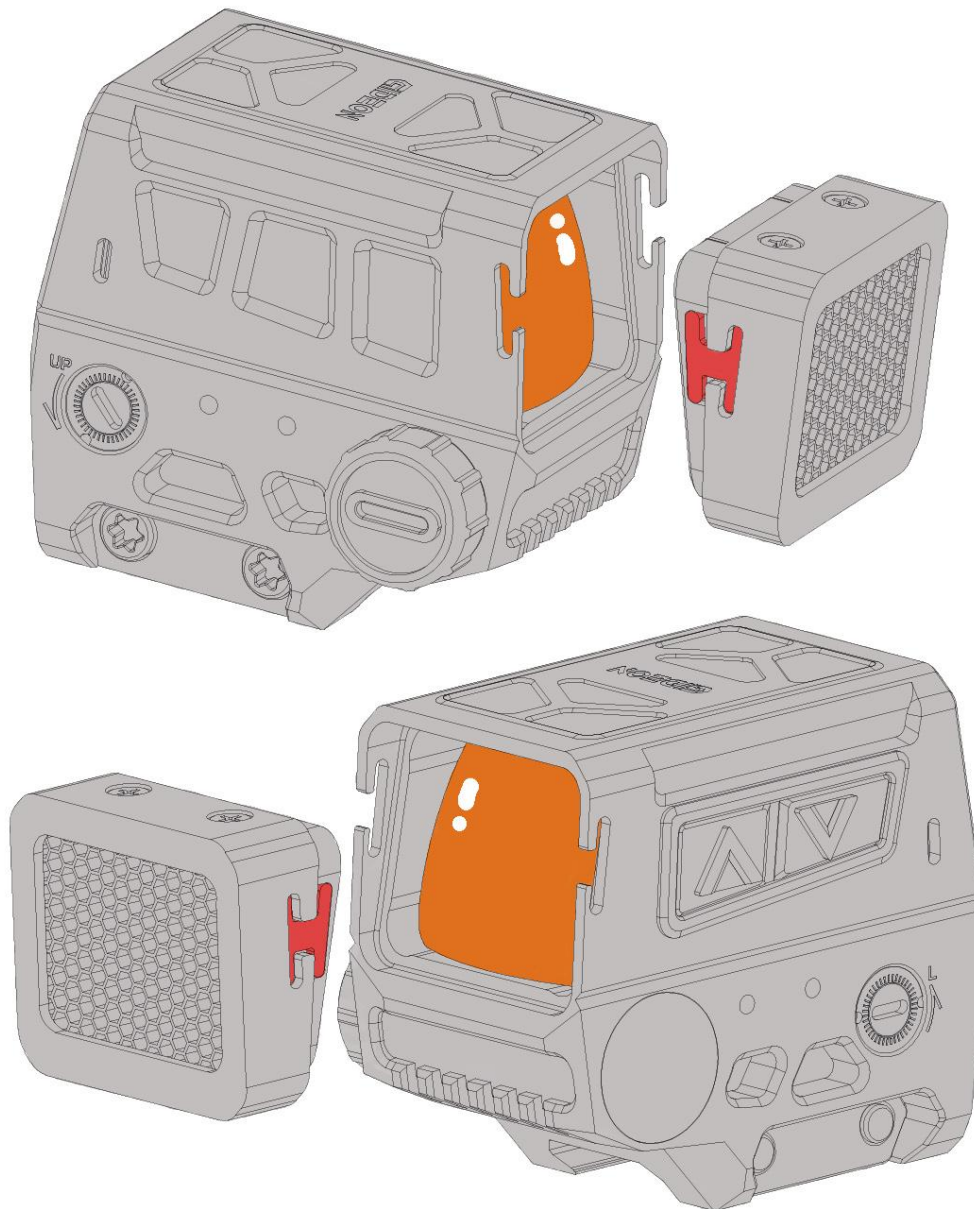

Figure 2

Mediator XL can be used without the ARD and in fact users will enjoy an improvement in visual clarity without the aluminum honeycomb in front of the glass. However, glare apparent to the user and reflective glint apparent on the opposite side will also be increased. The choice is yours depending on your priorities and use case.

CLEANING THE LENS

Blow away any dust or grit on the lens surface before wiping the lenses. Gently wipe the lenses clean with a soft and dry cloth. Glass cleaner is fine to use but keep harsh solvents and other gun cleaning chemicals away from the lens.

STORAGE

If possible, Mediator XL should be stored in a cool and dry place. Remove the battery from the battery compartment if the optic is to be stored for an extended period of time.

NOT USER SERVICABLE

DO NOT attempt to further disassemble any components of the Mediator XL optic. There's nothing in there you can fix. Disassembling the optic will void the warranty.

Limited Lifetime Warranty

Your Gideon Optics product is guaranteed for life against manufacturer defects or accidental breakage. If your product fails to function during normal and intended use, Gideon Optics will repair or replace it at our discretion, following evaluation by our service team. Cosmetic damage is not considered a covered "failure"—for example, if your optic is scratched and/or dented and has the finish rubbed off of it but still functions correctly, then it still works. Intentional abuse is likewise not covered—leave the torture tests to the guys on YouTube. Refinishing a Gideon Optic will not void the warranty provided you used an air dry type coating only. Do not put optics in ovens to "cure" a custom finish. In the event that a refinished optic must later be returned, you will receive a standard optic with black finish in exchange.